

Combined audible/optical signal SFL with strobe

Comax
Signaltechnik

General information

Electronic sounder with strobe in up-to-date technology. Selection of 32 different tones possible. Strobe 0,7J, frequency 1Hz. Attenuation of the sound pressure level by 10dB. Low current consumption. Separate control of strobe light and sounder.

Technical data

Case	ABS
-colour	white or red
Lens	PC
-colour	red, amber, blue, clear
Cable entry	flush mounting Ø 10,5 mm or M20 (option)
Sound output	Attenuation by 10dB
Tones	32 tones to be selected
Strobe	0,7J, 1Hz
Operation	continuous
Degree of protection	IP54, IP65 with deep or powered base
Installation	free
Temperature range	-10°C up to +55°C
Weight	ca. 330 g
Dimensions	height 92mm (with shallow base) height 121mm (with deep or powered base) diameter 93mm

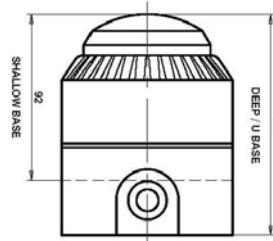
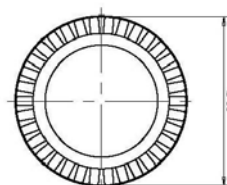

Order data

Item Number	Nominal tension	Output	Current	Case
SFL.012.21*	9-15VDC	101dB(A)	max. 140mA	red
SFL.012.26*	9-15VDC	101dB(A)	max. 140mA	white
SFL.024.21*	18-28VDC	101dB(A)	max. 100mA	red
SFL.024.26*	18-28VDC	101dB(A)	max. 100mA	white
SFL.230.71*	110-230VAC 50-60Hz	101dB(A)	max. 35mA	red
SFL.230.76*	110-230VAC 50-60Hz	101dB(A)	max. 35mA	white

Data of sound output and current consumption measured at 12VDC/24VDC/230VAC, tone 3

Colours of dome: 1 = red, 2 = amber, 5 = blue, 7 = clear

Options

B-SO.230.7*	Base 110-230VAC
A-SO.000.0*	Deep base, Knockouts being opposite
U-SO.000.0*	U-shape base, 2 Knockouts being on the same side

Case colours 1 = red, 6 = white

Technical modifications without prior notice

